

### Features

- Compact
- Reliable and Accurate
- Flexible Design
- Detection of Earth Leakage Current ! Panel Mount

### Input Specifications

Current Transformer Type	: Core Balance Current Transformer
Operating Current Range	: 10mA - 30A

### Environmental Specifications

Temperature	: Operating : 0° to 55°C
	: Storage : -20° to 75° C
Humidity (Non- Condensing)	: Upto 95% RH

### Mechanical Specifications (96X96)

Mounting	: Panel Mount
Wire Size (max)	: 0.2 - 1.5mm (AWG : 24 - 14)
Screw Tightening Torque	: 0.5 NM

## Dimensions

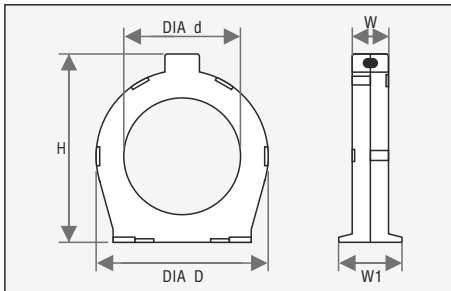

CBCT TYPE	DIMENSIONS				
	D	d	H	W	W1
CBCT-35-1	69	36.5	81	20	40
CBCT-70-1	107	71	119	20	40
CBCT-120-1	155	121	168	20	40
CBCT-210-1	253	210	268	34	55

## Ordering Information

Model No.	Inner Diameter
CBCT-35-1	35mm
CBCT-70-1	70mm
CBCT-120-1	120mm
CBCT-210-1	210mm